



UIL 4A Area D

Marching Band Manual

1440 W. Pecan St.
Pflugerville, TX 78660 Office:
(512) 594-1966



Congratulations to your students and staff on advancing to the Area D Marching Band Contest!! We are excited to host you and your program at The Pfield on October 21, 2023. We understand how important this day is for you and your program. To ensure that your show runs smoothly, and your arrival to our stadium is a good experience, we have provided information with details regarding bus parking, trailer parking, warm up areas, performers seating, and road maps for entering and exiting the stadium.

As an effort to improve safety and security, a clear bag policy will be enforced for all PflISD athletic home events at The Pfield sports complex. Approved and non-approved bags are shown below. Please review all Pfield guidelines at www.pflisd.net/athleticforms.

Storage areas have been provided for your front ensemble and props under the visitor side of the stadium on a first come, first serve basis. These areas are available for your convenience, however there will **NOT** be any secure monitoring of such equipment and storage areas.

Please be aware that the frequency bandwidth utilized at The Pfield is 24 ghz. PflISD recommends that you test your sound system **prior** to entering the stadium if you are utilizing wireless.

Performers are required to either wear their band uniforms or band shirts to gain admission into the visitor side of the stadium before and after their performance. Should a performer wish to be **seated** on the home side, they must purchase a ticket to do so. All students and directors will be allowed to enter the home side with their band shirt or badge for concessions and Pep Wear purchases.

Please encourage students, visitors, and parents to visit our Pep Wear center. This would be a great way to show support for your band programs. This center will be located at the front of the home side stadium entrance.

Map 1 – Provides information on the logistics of the stadium.

Map 2 – Provides you with information on arrival and staging of your tractors, trailers and buses. **Please be mindful that no personal vehicles will NOT be allowed in the staging area.** All others will need to park in the visitor parking. **Please make sure that your buses and trailers enter the stadium parking lot through the Pecan St. entrance as shown on map 2.** There will be a monitor at the entrance to guide your trailer and buses to their staging area. Please make sure that you collect your wristbands and turn in any forms or payments at the check in table.

Map 3 – Performance entrance path and post-performance exit path.

Map 4 –Visitor Parking

Food Drop Off – Please use the entrance off of Swenson Farms. If you are need of additional space, please use the PflISD administration parking lot across W. Pecan St.

Weather Protocol – PflISD policy states that we must evacuate the stadium when lightning is within an 8-mile radius. The event will be postponed for 30 minutes at the first warning of lightning. All spectators will proceed to their vehicles and students will be directed to their buses. We will have Timmerman Elementary available for those who do not have either of the two above options available. Timmerman Elementary is located behind The Pfield on the north-east side entrance.

Nurse/First Aid – Will be available on site. Please refer to map # 1 for nurses' location.

We will have monitors throughout the event to answer any questions you may have during the day. Concessions will be available on the home side of the stadium for your convenience. If you have any questions with regards to logistics of the stadium, please do not hesitate to contact me at any time. I have provided my office number and cell number on the contact page. We are here to serve you in the best possible way we can. We wish you and your program a successful performance at the Area D Marching Contest.





5A Area D Marching Band Field Logistics

Map 1

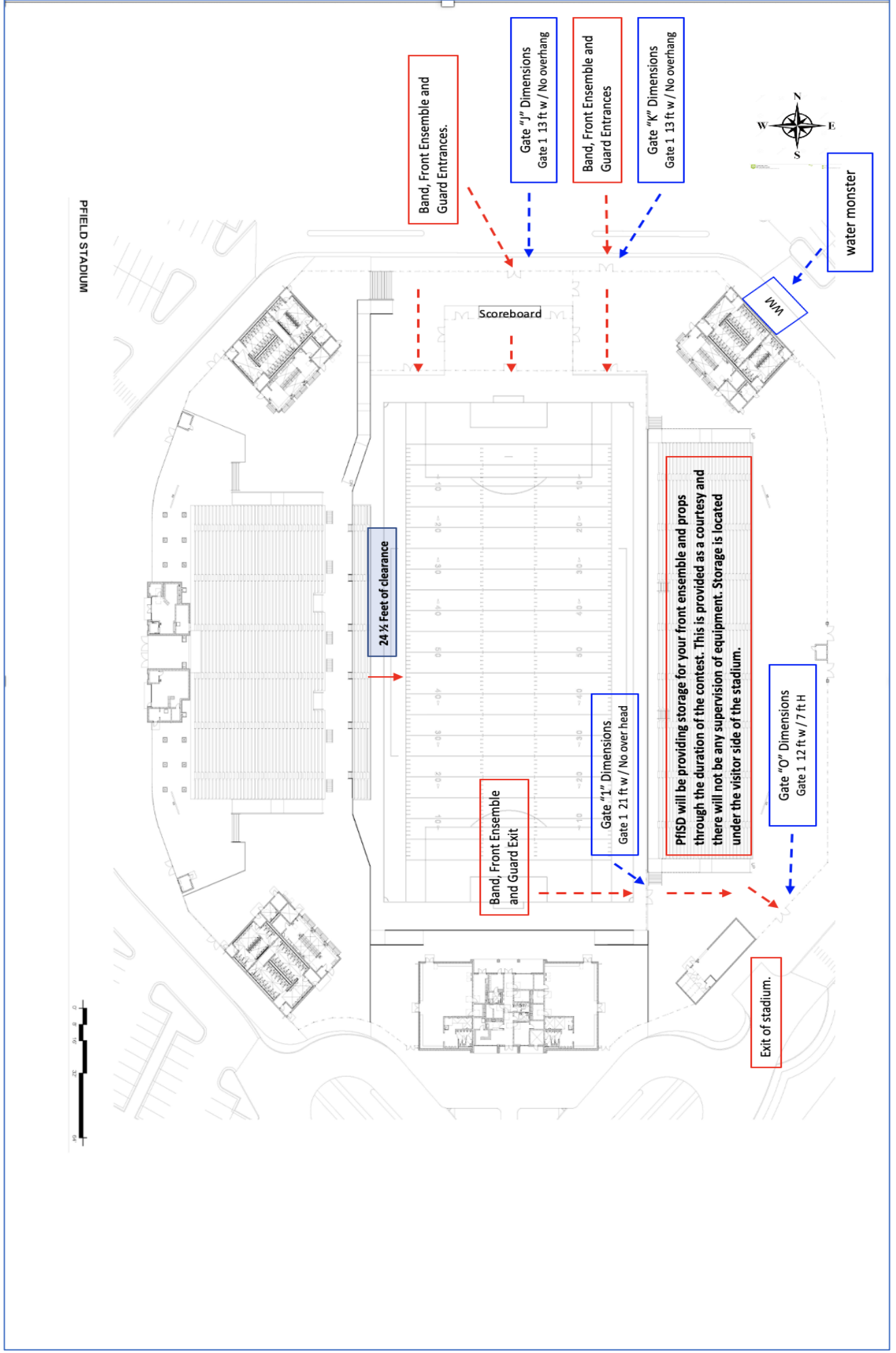



5A Area D Marching Band

Arrival & Staging Information

Map 2

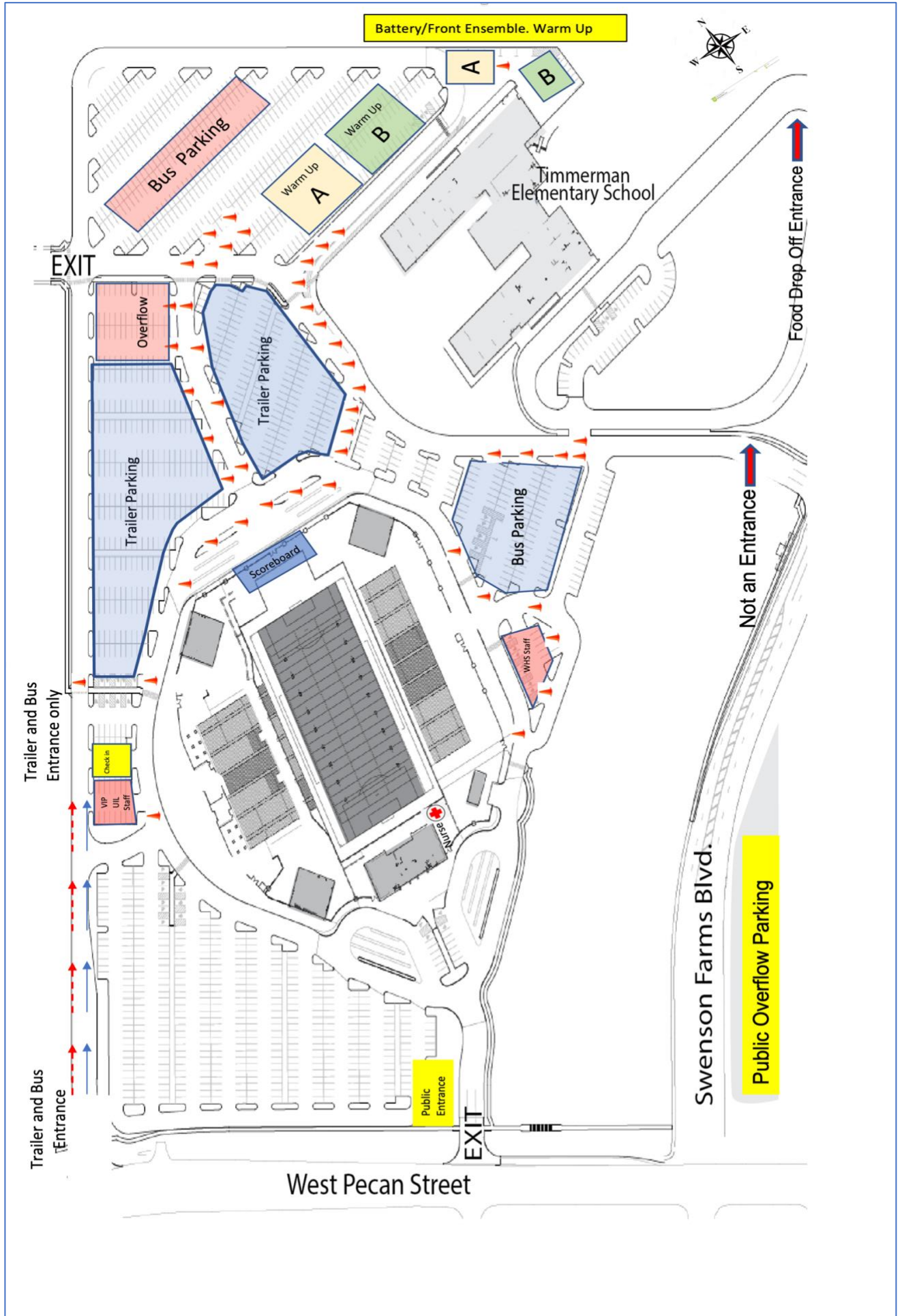



5A Area D Marching Band Student Monitor Route

Map 3

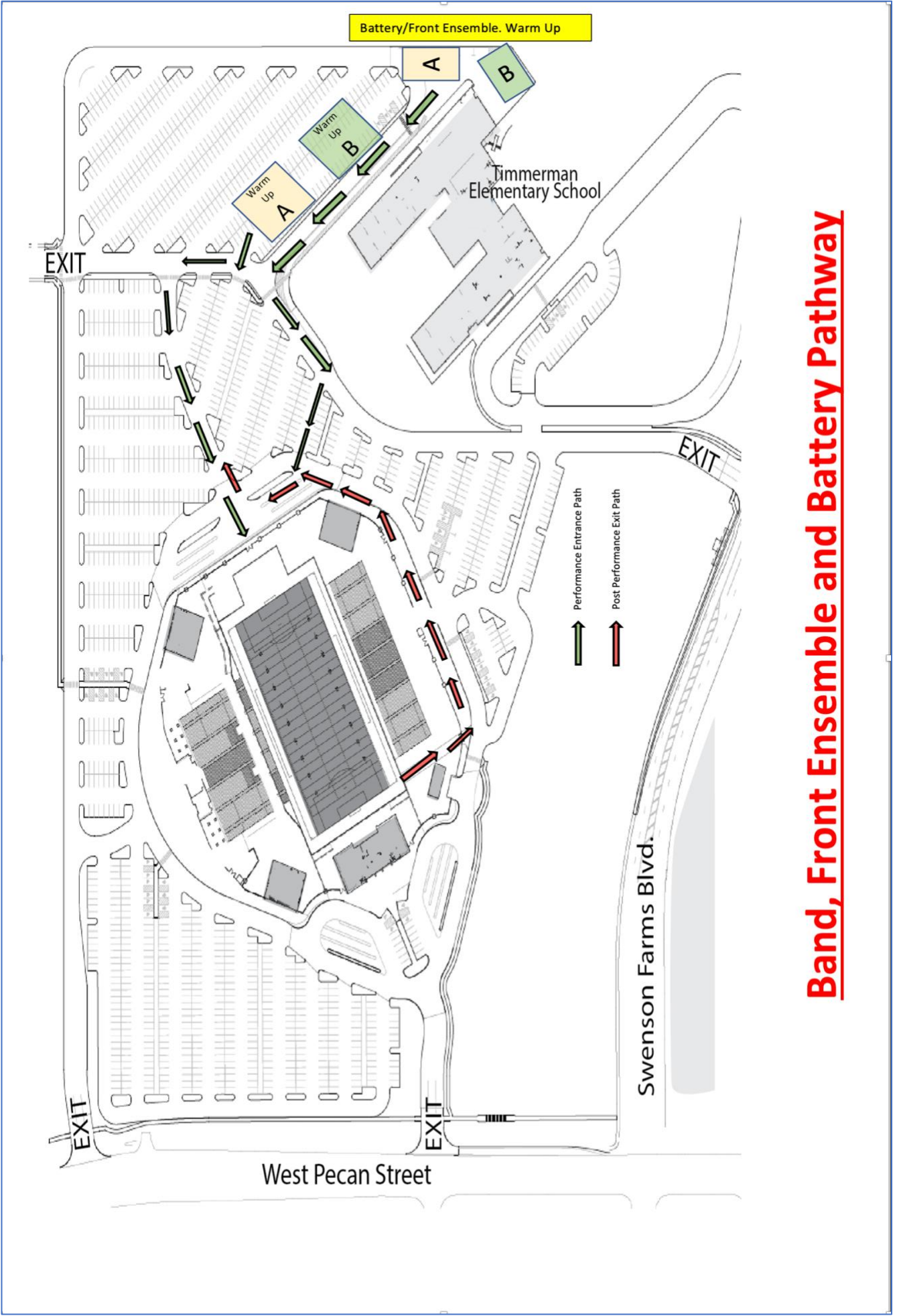

Band, Front Ensemble and Battery Pathway



5A Area D Marching Band

Visitor Parking

Map 4

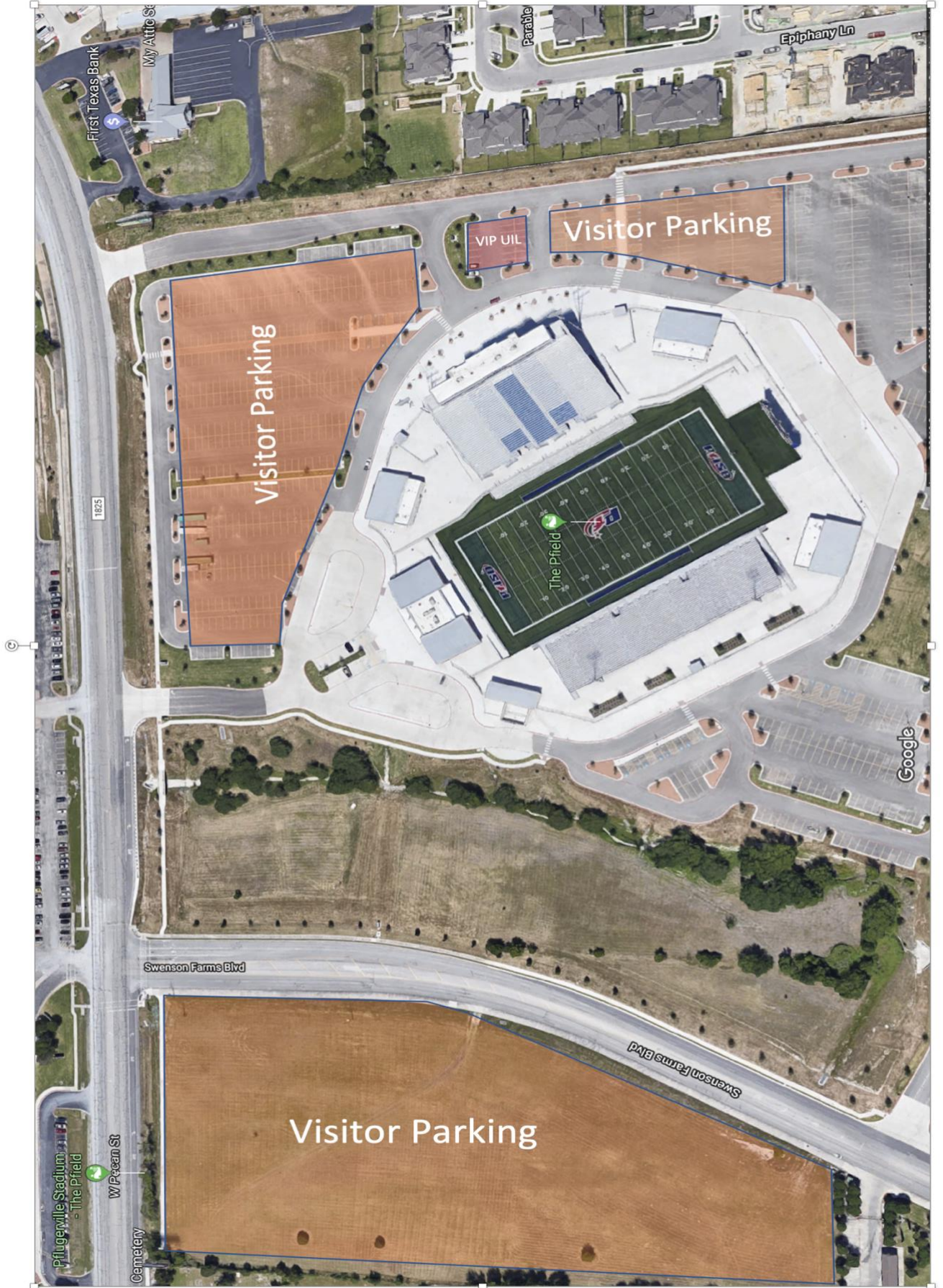



Superintendent of Schools– Dr. Doug Killian

Fine Arts Director – Manuel Gamez

Cell: 915-474-4363

Email: manuel.gamez@pfisd.net

Fine Arts Specialist – Sarah Martinez

Fine Arts Sr. Administrative Associate – Elizabeth Araujo

Fine Arts Accounting Specialist – Lori Lesikar

Fine Arts Accounting Specialist – Lizette Valles

Fine Arts Office Phone – (512) 594-1966

Athletic Director – James Mceachern

Assistant Athletic Director – Jesse McCartney

Athletic Accounting Specialist – Sue Benyo

Athletic Administrative Associate – Jennifer Taylor

Athletics Office Phone – (512) 594-9500